

INSTALLATION INSTRUCTIONS

DESCRIPTION: 4 Point Harness Mount Kit
PART NUMBER: B5H-F47K0-V0
MODEL: '19 ~ YXZ1000R



⚠ WARNING

Please read and understand these instructions completely before installation to avoid possible injury, or damage to the accessory or vehicle.

DEALER OR INSTALLER:

These instructions contain important information for future reference and *must* be given to the customer.

This kit is installed in combination with the 4 Point Harness Seat Belt Kit p/n **B57-F47K0-V0**

WARRANTY INFORMATION:

In the U.S., see your Yamaha dealer for a copy of the Yamaha Genuine Parts and Accessories limited warranty statement.

⚠ WARNING

Failure to install seat belts correctly could result in serious injury or death. Check harness fit before and during each ride. Rough riding will tend to settle belts and loosen them.

NOTICE:

This installation requires a torque wrench and should be performed by an authorized Yamaha dealer or other qualified technician.

PARTS LIST:

No.	Part Number	Description	Qty
--	B5H-F47K0-V0	4 Point Harness Mount Kit	--
①	*	Harness Holder – Passenger Side	1
②	*	Harness Clamp	2
③	*	Harness Holder – Driver Side	1
④	*	M8x25 Hex Socket Bolt	12

* Part supplied with kit only and not available separately.

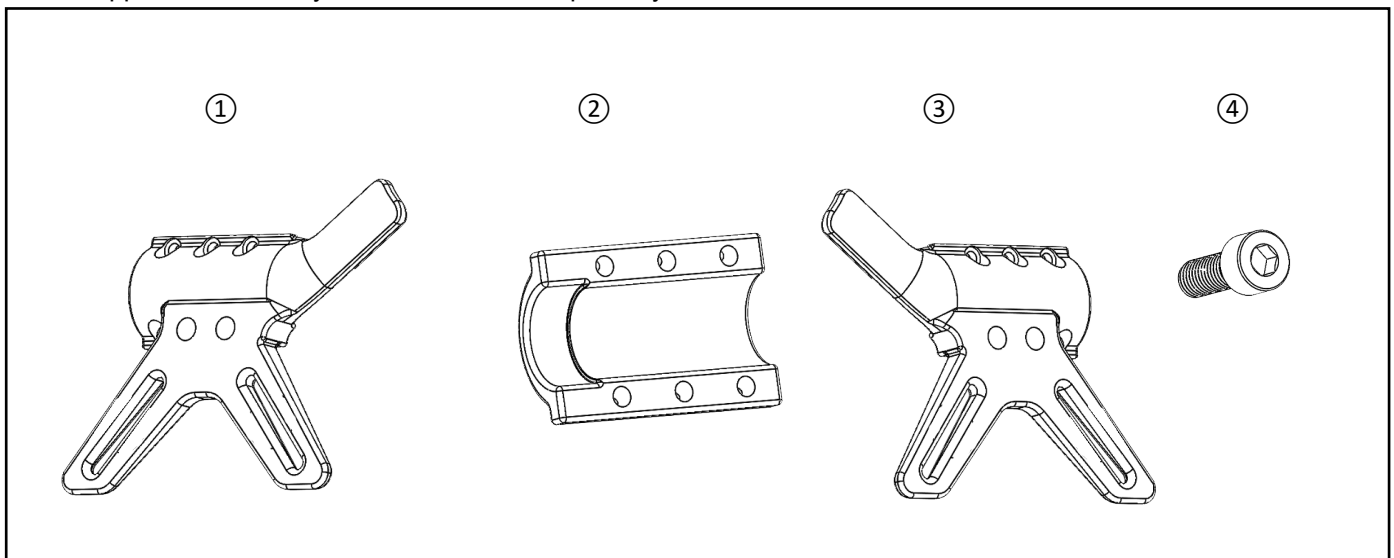

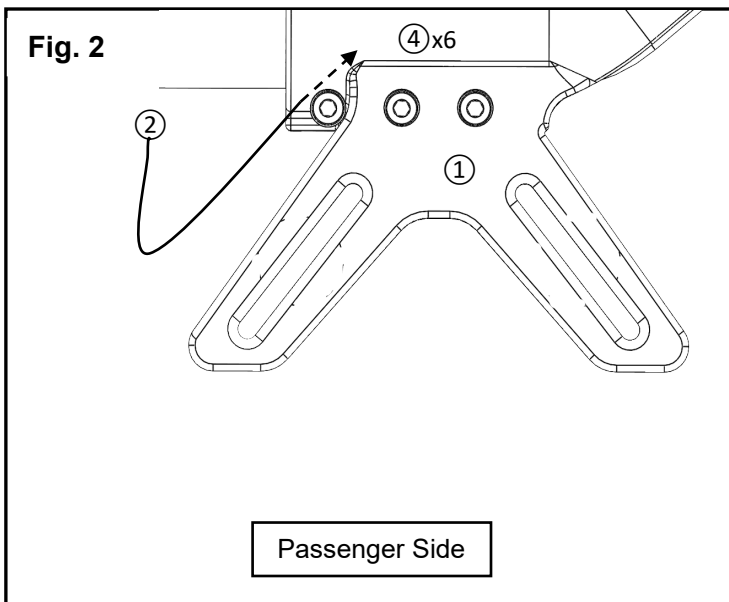
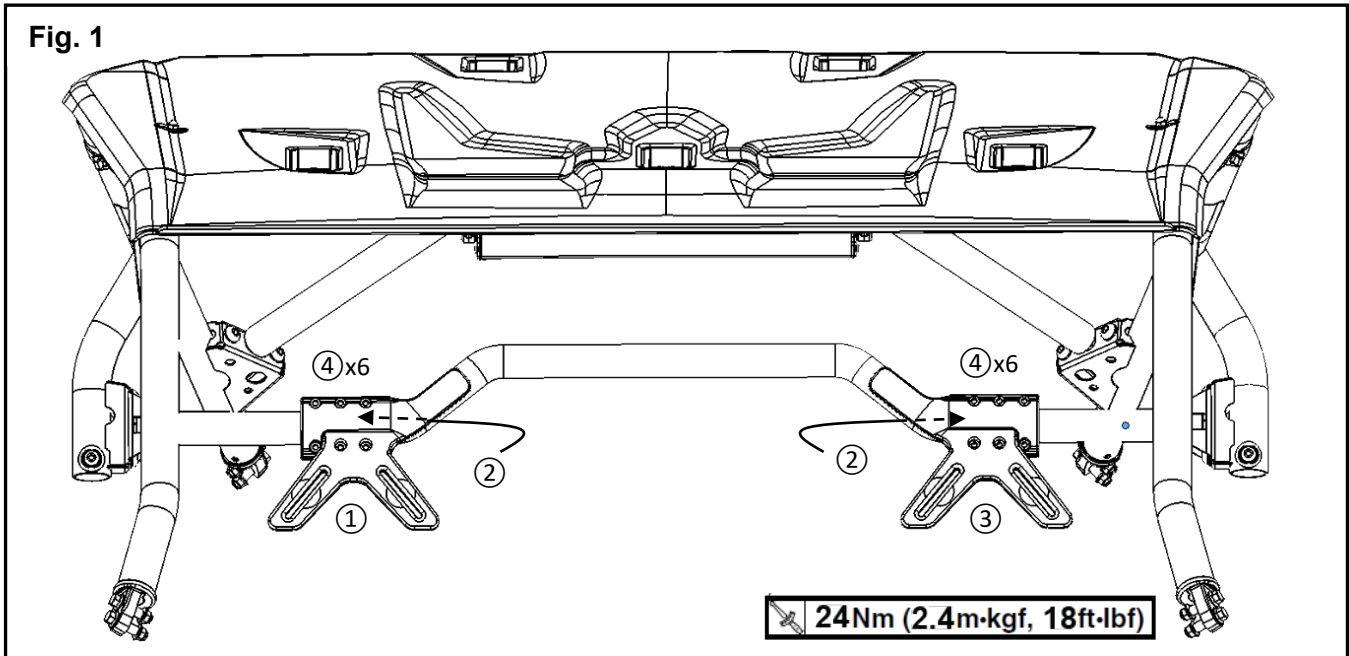

PREPARATION:

- Place the vehicle on a secure and level surface.
- Set the parking brake.
- Clean the mount surfaces before starting installation.

INSTALLATION:

1. Remove driver and passenger seat. Refer to the service manual for vehicle diagrams and the order to follow to accomplish this task.

Have the 4 Point Harness Seat Belt Kit p/n **B57-F47K0-V0** ready to install –refer to that instruction to install the 4 point Harness Set.

2. Place the (3) Harness Holder – Passenger Side in position on the ROPS tube – refer to Fig. 1.
3. Install a (2) harness clamp to the back with the larger opening toward the center of the vehicle – refer to Fig. 3. Thread in a (4) M8x25mm Socket Head Bolt. Leave loose.

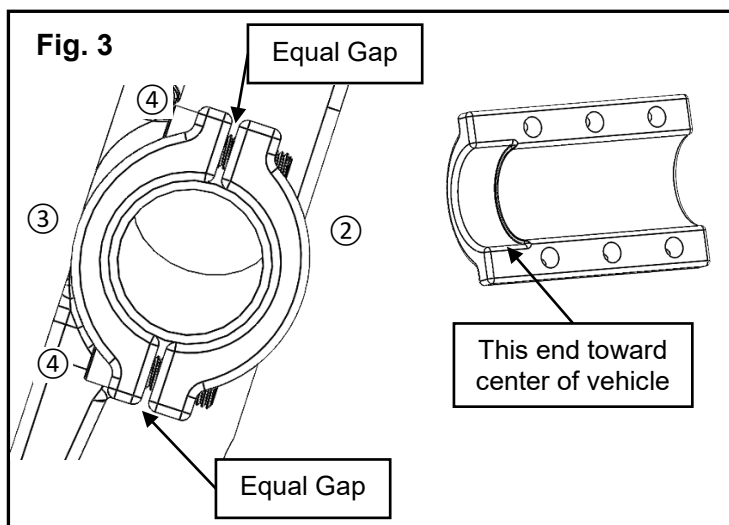

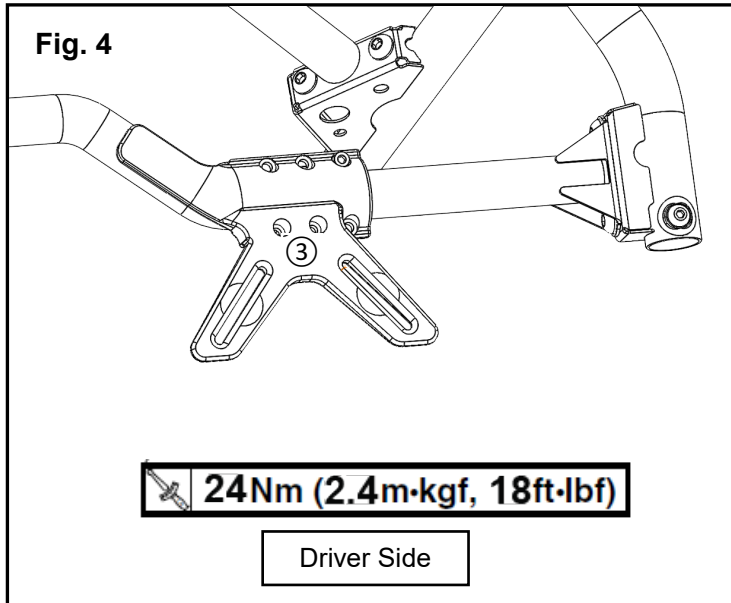

4. Install the other five ④ M8x25mm Socket Head Bolts and leave loose.
5. Adjust the Harness Holder along the ROPS tube so that it fits flush against the ROPS tubes as close to the 'bend' as possible.
6. Ensure gap is same on both. Tighten the center two bolts first. Neither side should bottom out. See Fig.3. The space between front and back halves of the clamp should be the same on either side – as shown.
7. Torque the six ④ Bolts to 24 NM (18ft·lbf)
8. Refer to the 4 point harness instructions to attach the belts to the mounts.
9. Repeat steps 2 through 8 to install the ① Harness Holder – Drivers Side. See Fig. 4
10. Belts mount around the outside of the slot in the bracket. See Seat Belt Harness instructions for proper belt installation.

MAINTENANCE:

Periodically, check the bolts for tightness. Retorque if needed.

CARE AND CLEANING:

Clean metal parts with a clean soft cloth and mild soap and water. Rinse with clean water and wipe dry with a soft clean cloth.

CUSTOMER SERVICE:

For further information see your Yamaha dealer.

ESTIMATED TIME TO INSTALL: 0.5 HRS